



Part number
CKSM 04



Brief description:

male insert, 4 poles + PE, spring terminal connections , 10A, 400V, 4kV, 3, silver plated, size "21.21", CLASS insert series

Product description		Approvals / Standards	
Model	male insert	Reference standard	EN 61984 (2001-11)
Version	spring terminal connections	Quality mark	 EAC
Series	CKS	Conformity	CQC, CE
Product type	with male contacts	General ordering information	
Family	CLASS inserts	EAN13 code	8015747164382
Size	size "21.21"	Tariff number	85369095
N. of poles	4 poles + 	Country of origin	Made in EU (IT)
Technical data		ETIM classification	EC000438
Current	10 A (A.C. and D.C.)	Packaging Information	
Voltage	400 V	Packaging length	210,00 mm
Rated impulse withstand voltage	4kV	Packaging height	200,00 mm
Pollution degree	3	Packaging width	130,00 mm
Wire cross-section	0,14 mm ² - 2,50 mm ²	Packaging weight	9,72 kg
AWG size	26 - 14	Packaging volume	5,46 dm ³
Operating temperature range (min, max)	-40°C ... +125°C	Packaging description	Carton box
Contacts material	Brass	Packaging quantity	200 Pcs
Contact type	silver plated	Packaging EAN code	8015747164436
Mating cycles	≥ 500	Sub-packaging weight	1,94 kg
IP degree of protection	IP20 without enclosure, IP44/IP66/IP67/IP68 and IP69 with enclosure	Sub-packaging description	Carton
PE connection type	Spring	Sub-packaging quantity	40 Pcs
PE terminal stripping length	9...11 mm	Sub-packaging EAN barcode	8015747164443
Tightening torque for PE connection	M4: 1,2 Nm, 10,6 lb.in (Ph2 or 1,0x5,5mm)		
Further technical details			
Characteristics according to EN 61984	10A 400V 4kV 3; 10A 690V 4kV 2		
Insulation resistance	≥ 10 GΩ		
Contact resistance	≤ 3 mΩ		
Rated voltage according to UL/CSA	600V		
UL 94 flammability rating	V-0		
Main contacts stripping length	9...11 mm		
Torque for main contact	M2,5: 0.4 Nm; 3.5 lb.in (0,5 x 3mm)		
Tightening torque for fixing screws	M3: 0.5 Nm; 4.4 lb.in (0.5x3 mm)		
Weight	16,20 g		

Part number

CKSM 04



Catalogue drawings

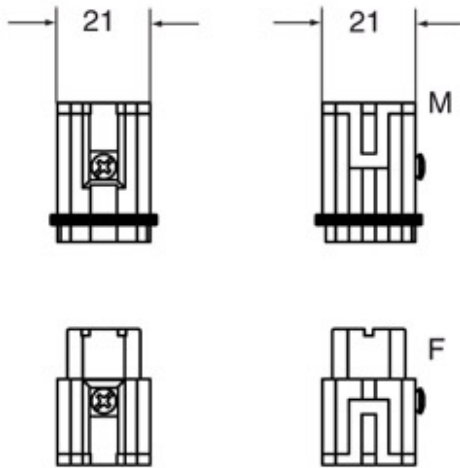

Catalogue drawings

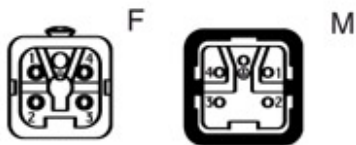
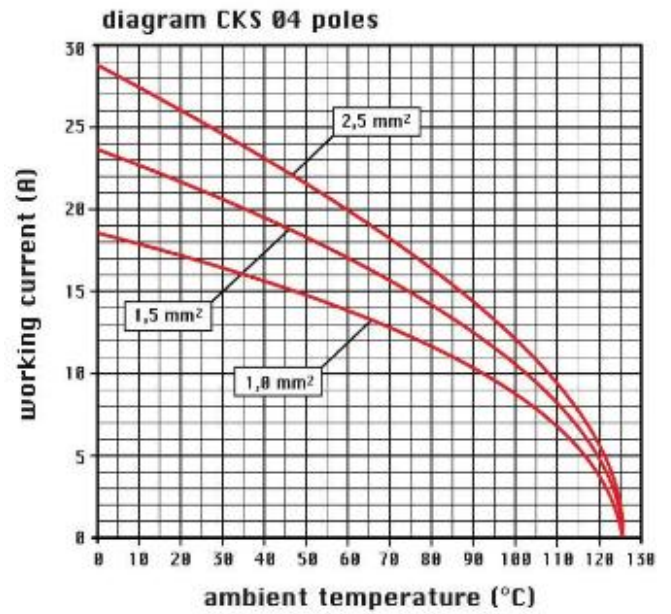

Notes

Spring terminal connections

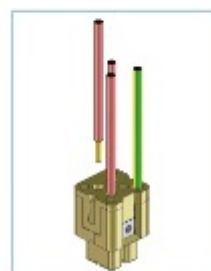
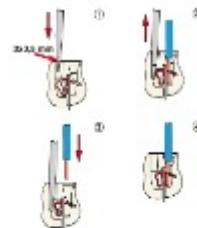

Rear top entry of wires for a more easier wiring.
